



CITY OF BAINBRIDGE ISLAND
EXECUTIVE DEPARTMENT

August 31, 2010

Re: Information Session for Proposed Improvements at Main and Ward Road Ends

Dear Neighbors:

The City's volunteer Road Ends Committee is responsible for researching, recommending and implementing use and development of street ends leading to water on Bainbridge Island. The Committee is currently considering plans to improve public access at the Ward and Main Road Ends.

In accordance with our procedures, the Road End Committee will hold an Information Session so that interested neighbors may learn about proposed plans and discuss ideas for improvements at the Ward and Main road ends.

The Information Session will take place Tuesday, September 14, 2010 from 7 – 8:30 pm at the Senior Center Commons at 370 Brien Dr. SE. Comments will be taken and ideas shared. If you are unable to attend the meeting, please submit comments by 4 pm September 17, 2010 to:

Road Ends Committee
City Hall/Cathie Currie
280 Madison Avenue North
Bainbridge Island WA 98110

BACKGROUND

The Road End Advisory Committee was formed in 1992 by Resolution 92-35 of the City Council. The Resolution was revised in 1996 as Resolution 96-44. The committee first met in November of 1992 and holds a monthly Regular Working session with additional cluster work parties as needed. On December 9, 1999, City Council passed Resolution 99-36 authorizing the Road End Advisory Committee to continue working with the added responsibility of overseeing the implementation of plans for improvements at road ends.

Two sections of the Revised Code of Washington (RCW) are important to the work of the Road Ends Committee. RCW 35.79.035 prohibits the vacation of rights-of-way abutting salt or fresh water. RCW 4.24.200 and 4.24.210 outline protection from liability granted to a property owner where public access for recreational purposes is allowed or in place.

Respectfully,

Road Ends Committee: Marci Burkel, Bob Campbell, Jack Christiansen, Don Fisher, Eric Hoyte, Vince Larson, Bitsy Ostenson, Roger van Gelder

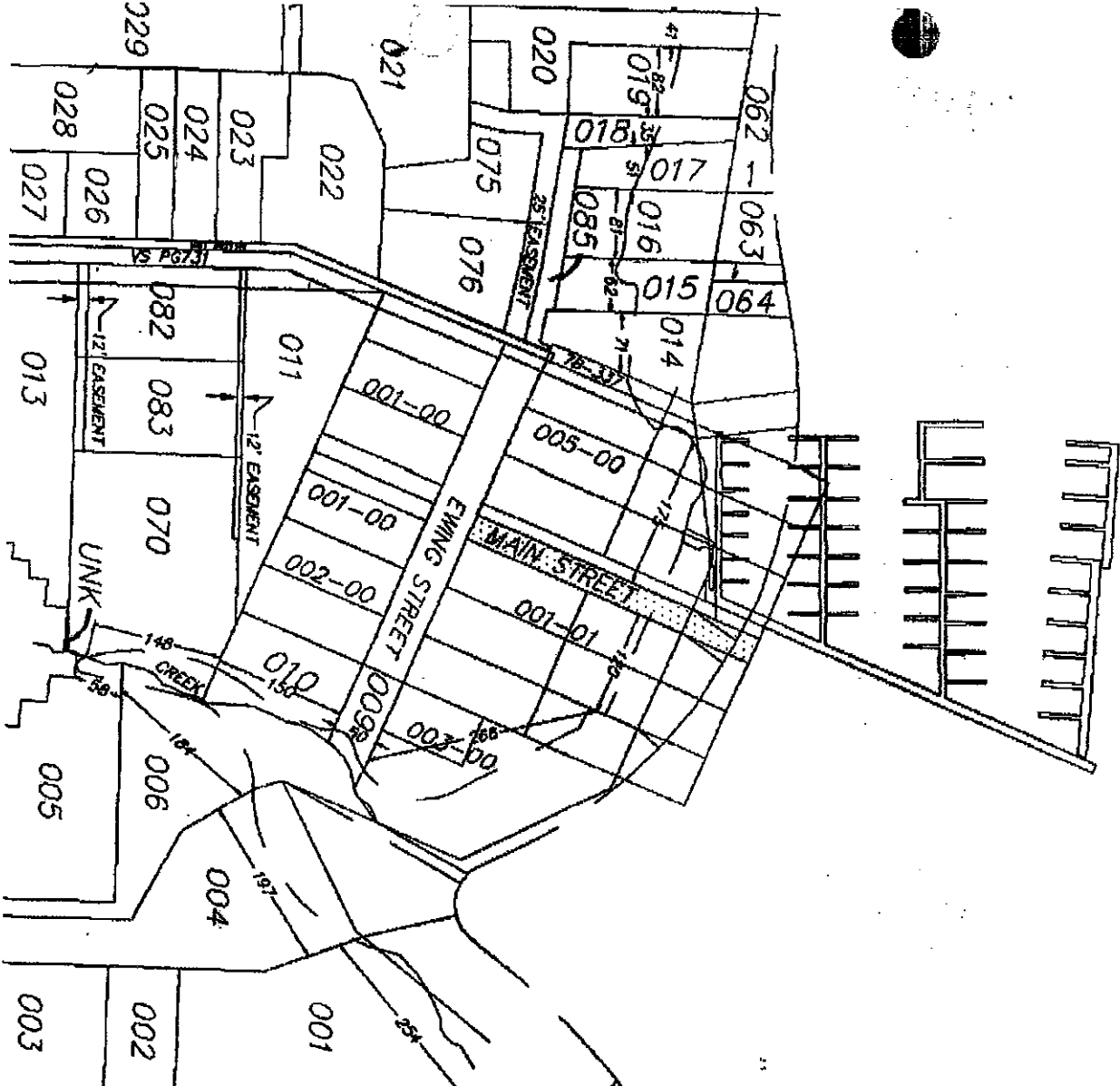

EAGLE HARBOR

TAYLOR AVENUE NE



MAP # 43
 SCALE 1" = 200'

001

SHORELINE

BEAVER

1288

T LOT 1
20/84

061

87

080 HEADR

081

062 - 063 - 064

GOVERNMENT LOT 2
PATENTED 10/10/71

EAGLE

NE EAGLE HARBOR ROAD

029

006

004

062

003

002

001

000

052

051

050

049

048

047

046

045

044

043

042

041

040

039

038

037

036

035

034

033

032

031

030

029

028

027

026

025

024

023

022

021

020

019

018

017

016

015

014

013

012

011

010

009

008

007

006

005

004

003

002

001

000

UNK

082

081

080

079

078

077

076

075

074

073

072

071

070

069

068

067

066

065

064

063

062

061

060

059

058

057

056

055

054

053

052

051

050

049

048

047

046

045

044

043

042

041

040

039

038

037

036

035

034

033

032

031

030

029

028

027

026

025

024

023

022

021

020

019

018

017

016

015

014

013

012

011

010

009

008

007

006

005

004

003

002

001

000

UNK

082

081

080

079

078

077

076

075

074

073

072

071

070

069

068

067

066

065

064

063

062

061

060

059

058

057

056

055

054

053

052

051

050

049

048

047

046

045

044

043

042

041

040

039

038

037

036

035

034

033

032

031

030

029

028

027

026

025

024

023

022

021

020

019

018

017

016

015

014

013

012

011

010

009

008

007

006

005

004

003

002

001

000

UNK

082

081

080

079

078

077

076

075

074

073

072

071

070

069

068

067

066

065

064

063

062

061

060

059

058

057

056

055

054

053

052

051

050

049

048

047

046

045

044

043

042

041

040

039

038

037

036

035

034

033

032

031

030

029

028

027

026

025

024

023

022

021

020

019

018

017

016

015

014

013

012

011

010

009

008

007

006

005

004

003

002

001

000

UNK

082

081

080

079

078

077

076

075

074

073